

# **M3 Junction 9 Improvement**

**Scheme Number: TR010055**

## **2.14 Revoking Existing Clearway Orders Plans (Rev 1)**

**APFP Regulations 5(2)(o)**

**Planning Act 2008**

**Infrastructure Planning (Applications: Prescribed Forms and  
Procedure) Regulations 2009**

**Volume 2**

**15 June 2023**



NOTES  
 Purpose of use  
**APPLICATION SUBMISSION**  
 Development Consent Order Number / Document  
 TR010055/2.14

1. THIS DRAWING HAS BEEN PRODUCED USING CAD SOFTWARE. THEREFORE ALL DIMENSIONS ARE SHOWN IN METRES UNLESS SHOWN OTHERWISE.  
 2. DO NOT SCALE FROM THIS DRAWING. USE ONLY PRINTED DIMENSIONS.

KEY TO SYMBOLS  
 DEVELOPMENT CONSENT ORDER BOUNDARY

REV	DATE	REVISION NOTE	ORIG	CHKD	APPD
0	NOVEMBER 2022	APPLICATION SUBMISSION	GP	LC	MF

DESIGNER  

CONTRACTOR  

CLIENT  



PROJECT TITLE  
 M3 JUNCTION 9 IMPROVEMENT SCHEME

PROJECT STAGE  
 PCF STAGE 3

DRAWING TITLE  
 REVOKING EXISTING CLEARWAY ORDERS  
 APFP REGULATION 5(2)(c)  
 KEY PLAN  
 DOCUMENT REFERENCE: 2.14

SUITABILITY  
 APPLICATION SUBMISSION  
 SHEET SIZE: A1 SCALE: 1:12,500 STATUS: REV 0  
 DRAWING NUMBER  
 HES51511-VFK-LSI-X\_XXXX\_XX-DR-ZL-8033

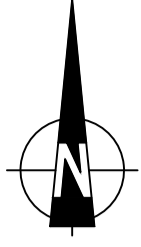
© Crown copyright and database rights 2022. Use of this data is subject to terms and conditions. Ordnance Survey Licence 100030649.



BASINGSTOKE

M3

PRIVATE FARM TRACK

PRIVATE FARM TRACK

FOR CONTINUATION SHEET 2 OF 10

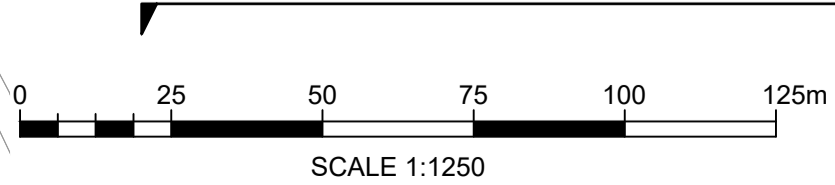

NOTES

Purpose of use  
**APPLICATION SUBMISSION**

Development Consent Order Number / Document  
TR010055/2.14

- THIS DRAWING HAS BEEN PRODUCED USING CAD SOFTWARE. THEREFORE ALL DIMENSIONS ARE SHOWN IN METRES UNLESS SHOWN OTHERWISE.
- DO NOT SCALE FROM THIS DRAWING. USE ONLY PRINTED DIMENSIONS.
- PROPOSED EARTHWORK EMBANKMENTS / CUTTINGS HAVE BEEN OMITTED FOR CLARITY.
- THE DESIGN SHOWN WILL BE SUBJECT TO DETAILED DESIGN DEVELOPMENT IN ACCORDANCE WITH THE PROVISIONS OF THE DEVELOPMENT CONSENT ORDER.

KEY TO SYMBOLS

- DEVELOPMENT CONSENT ORDER BOUNDARY
- LAND NOT INCLUDED IN ORDER LIMITS
- PROPOSED ROAD MARKINGS
- EXISTING CLEARWAY EXTENTS TO BE REVOKED
- START / END POINT AS DETAILED IN SCHEDULE 3 OF THE DEVELOPMENT CONSENT ORDER

01	JUNE 2023	DEADLINE 2	EO	LC	MF
0	NOVEMBER 2022	APPLICATION SUBMISSION	GP	LC	MF
REV	DATE	REVISION NOTE	ORIG	CHKD	APPD

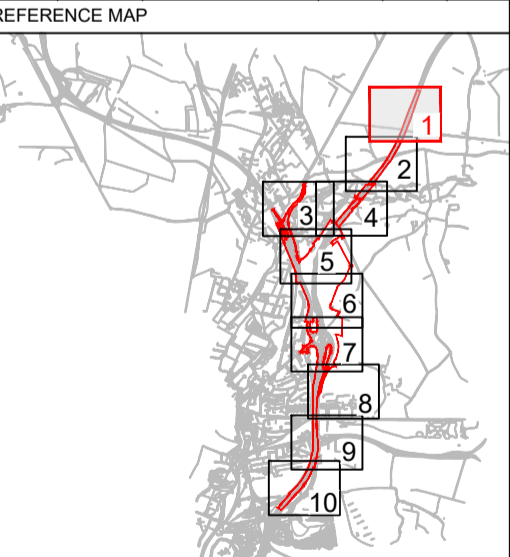

DESIGNER

CONTRACTOR

CLIENT

PROJECT TITLE  
M3 JUNCTION 9 IMPROVEMENT SCHEME

PROJECT STAGE  
PCF STAGE 3

DRAWING TITLE  
REVOKING EXISTING CLEARWAY ORDERS  
APFP REGULATION 5(2)(c)  
SHEET 1 OF 10  
DOCUMENT REFERENCE: 2.14

SUITABILITY  
APPLICATION SUBMISSION

SHEET SIZE: A1 SCALE: 1:1250 STATUS: REV 01  
DRAWING NUMBER  
HES51511-VFK-LSI-X\_XXXX\_XX-DR-ZL-8034

© Crown copyright and database rights 2022. Use of this data is subject to terms and conditions. Ordnance Survey Licence 100030640

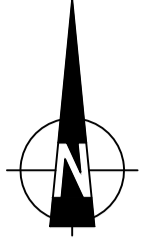

FOR CONTINUATION SHEET 1 OF 10

NOTES

Purpose of use  
**APPLICATION SUBMISSION**

Development Consent Order Number / Document  
**TR010055/2.14**

- THIS DRAWING HAS BEEN PRODUCED USING CAD SOFTWARE. THEREFORE ALL DIMENSIONS ARE SHOWN IN METRES UNLESS SHOWN OTHERWISE.
- DO NOT SCALE FROM THIS DRAWING. USE ONLY PRINTED DIMENSIONS.
- PROPOSED EARTHWORK EMBANKMENTS / CUTTINGS HAVE BEEN OMITTED FOR CLARITY.
- THE DESIGN SHOWN WILL BE SUBJECT TO DETAILED DESIGN DEVELOPMENT IN ACCORDANCE WITH THE PROVISIONS OF THE DEVELOPMENT CONSENT ORDER.

KEY TO SYMBOLS

- DEVELOPMENT CONSENT ORDER BOUNDARY
- LAND NOT INCLUDED IN ORDER LIMITS
- PROPOSED ROAD MARKINGS
- EXISTING CLEARWAY EXTENTS TO BE REVOKED
- START / END POINT AS DETAILED IN SCHEDULE 3 OF THE DEVELOPMENT CONSENT ORDER

ABBOTS WORTHY

B3047

M3

B3047

B3047

RIVER ITCHEN

RIVER ITCHEN

FOR CONTINUATION SHEET 3 OF 10

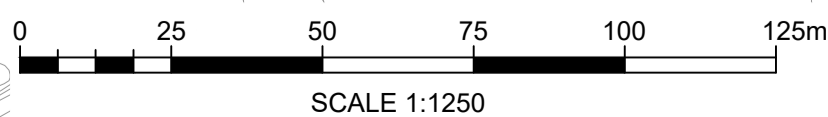

REV	DATE	REVISION NOTE	ORIG	CHKD	APPD
01	JUNE 2023	DEADLINE 2	EO	LC	MF
0	NOVEMBER 2022	APPLICATION SUBMISSION	GP	LC	MF

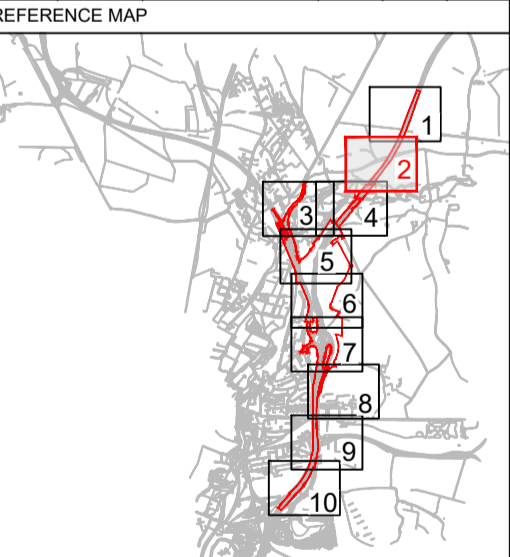

DESIGNER

CONTRACTOR

CLIENT

PROJECT TITLE  
M3 JUNCTION 9 IMPROVEMENT SCHEME

PROJECT STAGE  
PCF STAGE 3

DRAWING TITLE  
REVOKING EXISTING CLEARWAY ORDERS  
APFP REGULATION 5(2)(o)  
SHEET 2 OF 10  
DOCUMENT REFERENCE: 2.14

SUITABILITY  
APPLICATION SUBMISSION

SHEET SIZE: A1 SCALE: 1:1,250 STATUS: REV 01  
DRAWING NUMBER  
HES51511-VFK-LSI-X\_XXXX\_XX-DR-ZL-8035

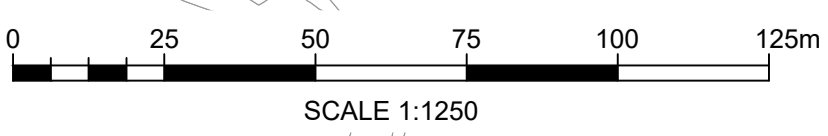
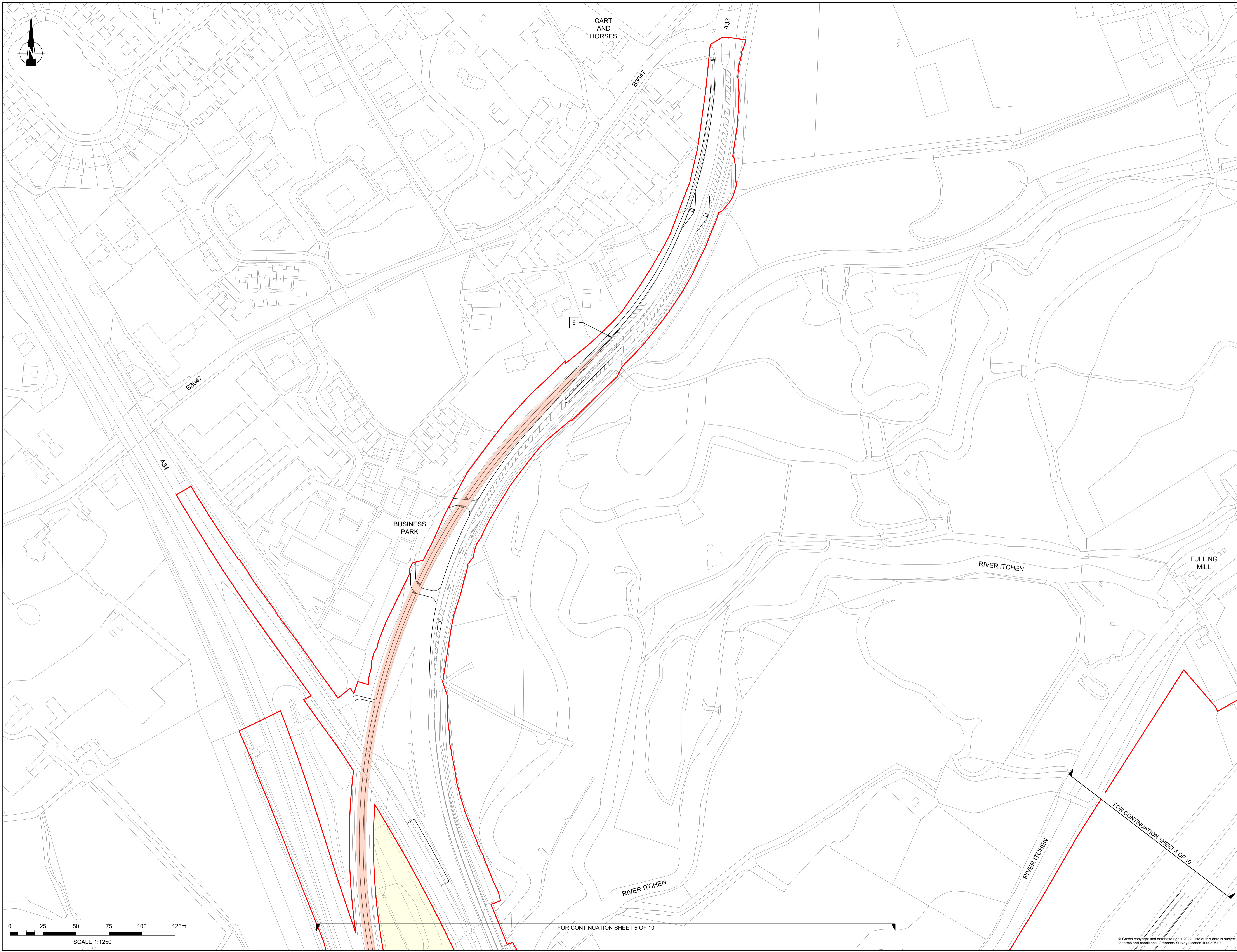

NOTES  
 Purpose of use  
**APPLICATION SUBMISSION**  
 Development Consent Order Number / Document  
**TR010055/2.14**

- THIS DRAWING HAS BEEN PRODUCED USING CAD SOFTWARE. THEREFORE ALL DIMENSIONS ARE SHOWN IN METRES UNLESS SHOWN OTHERWISE.
- DO NOT SCALE FROM THIS DRAWING. USE ONLY PRINTED DIMENSIONS.
- PROPOSED EARTHWORK EMBANKMENTS / CUTTINGS HAVE BEEN OMITTED FOR CLARITY.
- THE DESIGN SHOWN WILL BE SUBJECT TO DETAILED DESIGN DEVELOPMENT IN ACCORDANCE WITH THE PROVISIONS OF THE DEVELOPMENT CONSENT ORDER.

KEY TO SYMBOLS

- DEVELOPMENT CONSENT ORDER BOUNDARY
- LAND NOT INCLUDED IN ORDER LIMITS
- PROPOSED ROAD MARKINGS
- EXISTING CLEARWAY EXTENTS TO BE REVOKED
- START / END POINT AS DETAILED IN SCHEDULE 3 OF THE DEVELOPMENT CONSENT ORDER

01	JUNE 2023	DEADLINE 2	EO	LC	MF
0	NOVEMBER 2022	APPLICATION SUBMISSION	GP	LC	MF
REV	DATE	REVISION NOTE	ORIG	CHKD	APPD

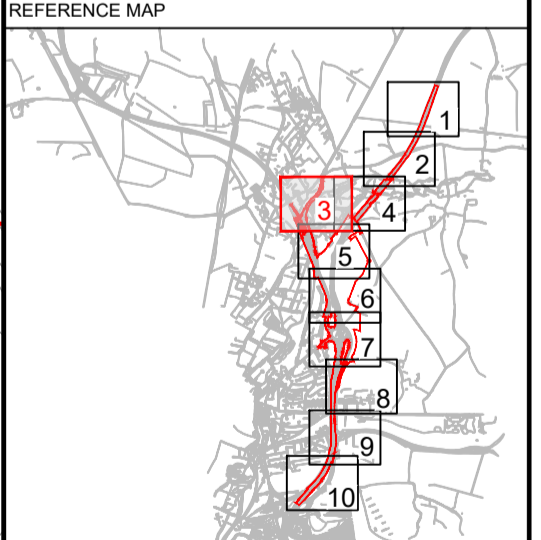

DESIGNER  
**Stantec**

CONTRACTOR  
**VolkerFitzpatrick**

CLIENT  
**national highways**

PROJECT TITLE  
**M3 JUNCTION 9 IMPROVEMENT SCHEME**

PROJECT STAGE  
**PCF STAGE 3**

DRAWING TITLE  
**REVOKING EXISTING CLEARWAY ORDERS  
 APFP REGULATION 5(2)(o)  
 SHEET 3 OF 10  
 DOCUMENT REFERENCE: 2.14**

SUITABILITY  
**APPLICATION SUBMISSION**

SHEET SIZE: A1 SCALE: 1:1,250 STATUS: REV 01  
 DRAWING NUMBER  
**HES51511-VFK-LSI-X\_XXXX\_XX-DR-ZL-8036**

FOR CONTINUATION SHEET 5 OF 10

FOR CONTINUATION SHEET 4 OF 10

© Crown copyright and database rights 2022. Use of this data is subject to terms and conditions. Ordnance Survey Licence: 100030449

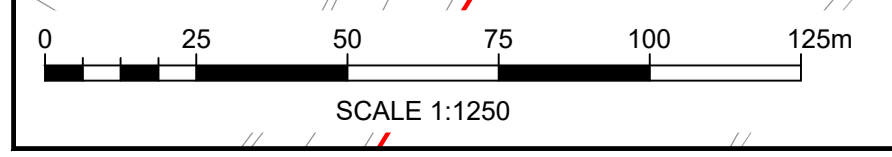
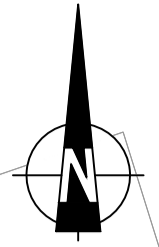
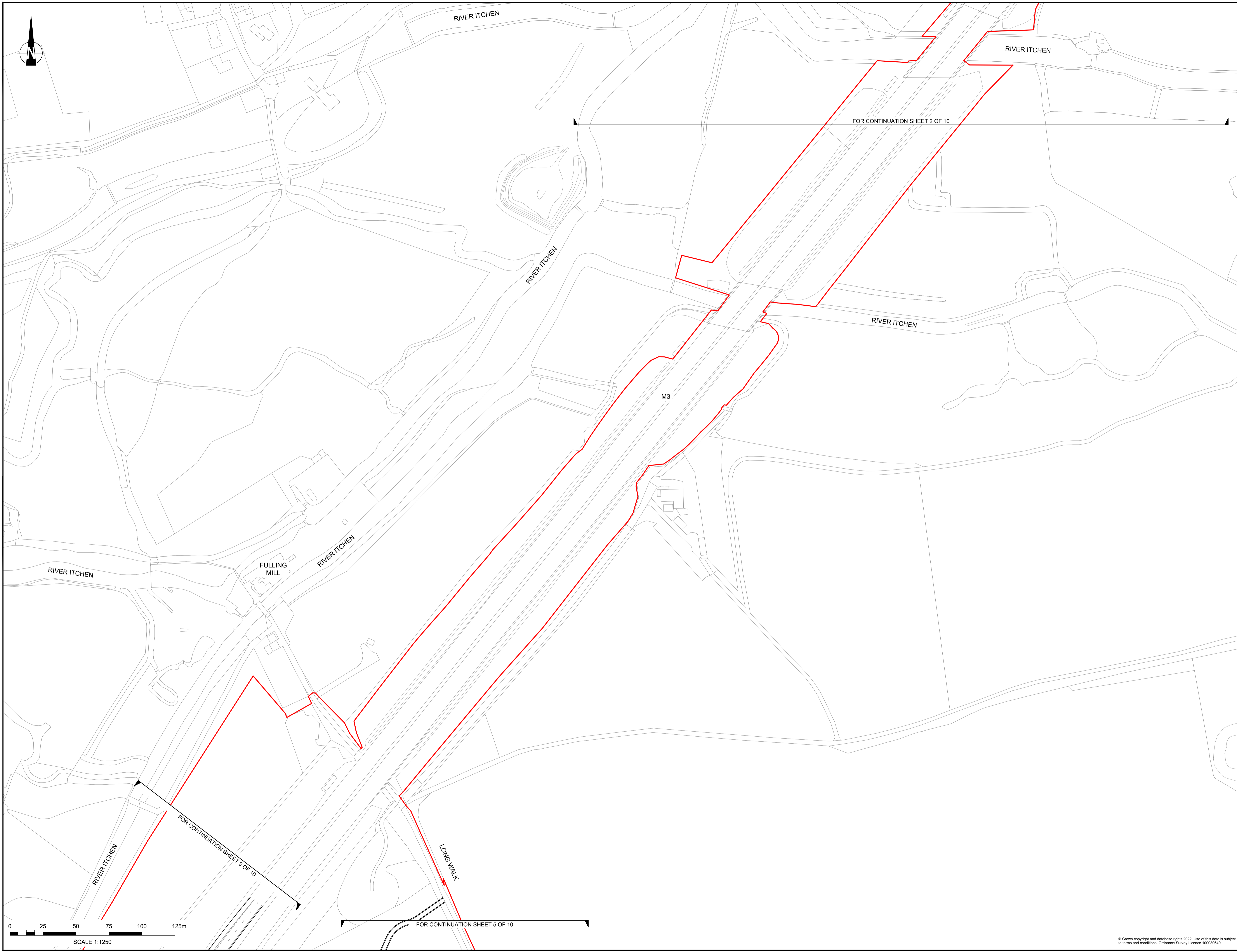

**NOTES**

Purpose of use  
**APPLICATION SUBMISSION**

Development Consent Order Number / Document  
 TR010055/2.14

- THIS DRAWING HAS BEEN PRODUCED USING CAD SOFTWARE. THEREFORE ALL DIMENSIONS ARE SHOWN IN METRES UNLESS SHOWN OTHERWISE.
- DO NOT SCALE FROM THIS DRAWING. USE ONLY PRINTED DIMENSIONS.
- PROPOSED EARTHWORK EMBANKMENTS / CUTTINGS HAVE BEEN OMITTED FOR CLARITY.
- THE DESIGN SHOWN WILL BE SUBJECT TO DETAILED DESIGN DEVELOPMENT IN ACCORDANCE WITH THE PROVISIONS OF THE DEVELOPMENT CONSENT ORDER.

**KEY TO SYMBOLS**

- DEVELOPMENT CONSENT ORDER BOUNDARY
- LAND NOT INCLUDED IN ORDER LIMITS
- PROPOSED ROAD MARKINGS
- EXISTING CLEARWAY EXTENTS TO BE REVOKED
- 1 START / END POINT AS DETAILED IN SCHEDULE 3 OF THE DEVELOPMENT CONSENT ORDER

REV	DATE	REVISION NOTE	ORIG	CHKD	APPD
01	JUNE 2023	DEADLINE 2	EO	LC	MF
0	NOVEMBER 2022	APPLICATION SUBMISSION	GP	LC	MF

**REFERENCE MAP**

**DESIGNER**

**CONTRACTOR**

**CLIENT**

**PROJECT TITLE**  
 M3 JUNCTION 9 IMPROVEMENT SCHEME

**PROJECT STAGE**  
 PCF STAGE 3

**DRAWING TITLE**  
 REVOKING EXISTING CLEARWAY ORDERS  
 APFP REGULATION 5(2)(c)  
 SHEET 4 OF 10  
 DOCUMENT REFERENCE: 2.14

**SUITABILITY**  
 APPLICATION SUBMISSION

SHEET SIZE: A1    SCALE: 1:1,250    STATUS: REV 01

**DRAWING NUMBER**  
 HES51511-VFK-LSI-X\_XXXX\_XX-DR-ZL-8037

© Crown copyright and database rights 2022. Use of this data is subject to terms and conditions. Ordnance Survey Licence 100030649.

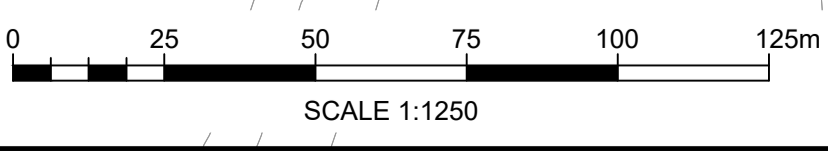
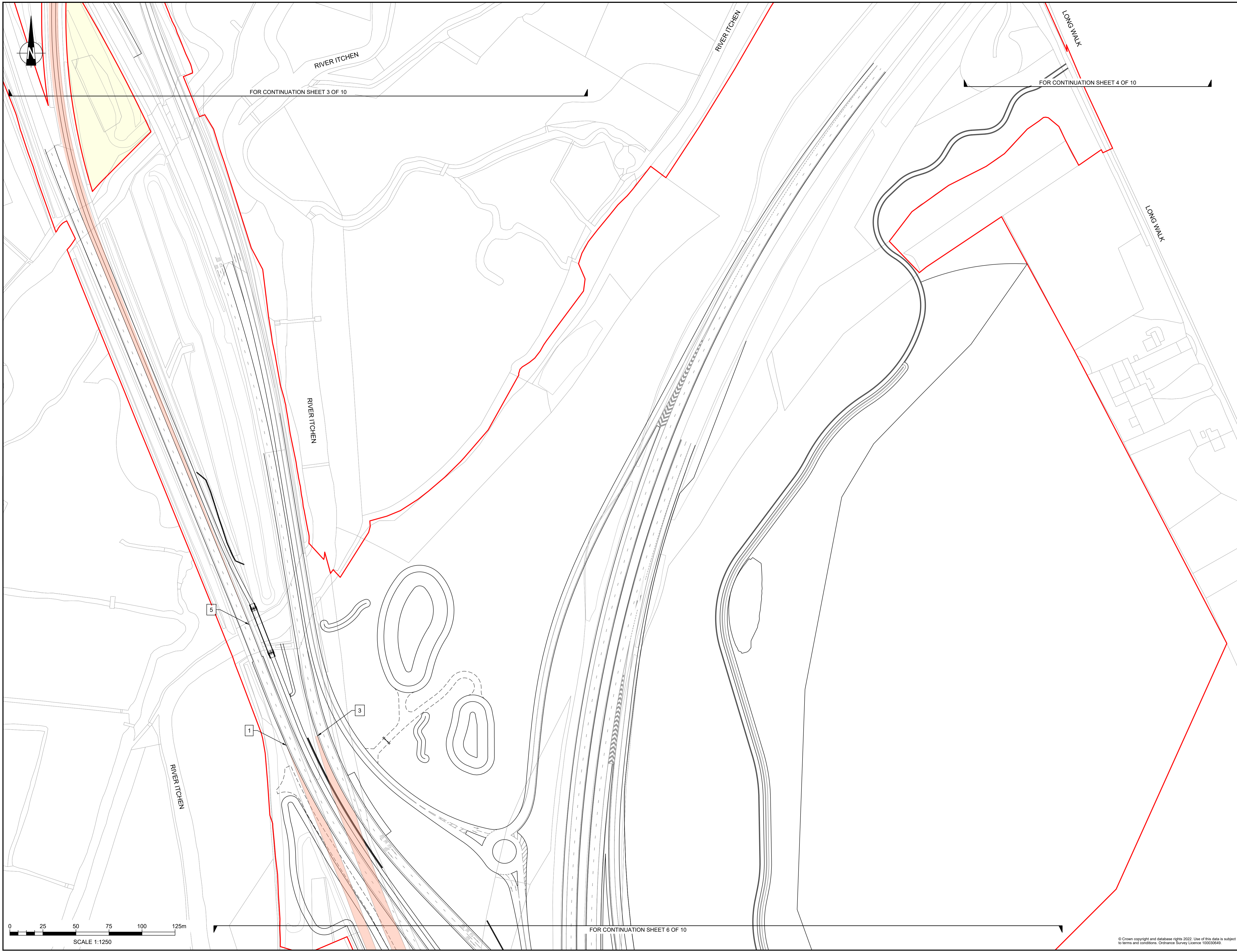

**NOTES**

Purpose of use  
**APPLICATION SUBMISSION**

Development Consent Order Number / Document  
 TR010055/2.14

- THIS DRAWING HAS BEEN PRODUCED USING CAD SOFTWARE. THEREFORE ALL DIMENSIONS ARE SHOWN IN METRES UNLESS SHOWN OTHERWISE.
- DO NOT SCALE FROM THIS DRAWING. USE ONLY PRINTED DIMENSIONS.
- PROPOSED EARTHWORK EMBANKMENTS / CUTTINGS HAVE BEEN OMITTED FOR CLARITY.
- THE DESIGN SHOWN WILL BE SUBJECT TO DETAILED DESIGN DEVELOPMENT IN ACCORDANCE WITH THE PROVISIONS OF THE DEVELOPMENT CONSENT ORDER.

**KEY TO SYMBOLS**

- DEVELOPMENT CONSENT ORDER BOUNDARY
- LAND NOT INCLUDED IN ORDER LIMITS
- PROPOSED ROAD MARKINGS
- EXISTING CLEARWAY EXTENTS TO BE REVOKED
- 1 START / END POINT AS DETAILED IN SCHEDULE 3 OF THE DEVELOPMENT CONSENT ORDER

REV	DATE	REVISION NOTE	ORIG	CHKD	APPD
01	JUNE 2023	DEADLINE 2	EO	LC	MF
0	NOVEMBER 2022	APPLICATION SUBMISSION	GP	LC	MF

**REFERENCE MAP**

**DESIGNER**

**CONTRACTOR**

**CLIENT**

**PROJECT TITLE**  
 M3 JUNCTION 9 IMPROVEMENT SCHEME

**PROJECT STAGE**  
 PCF STAGE 3

**DRAWING TITLE**  
 REVOKING EXISTING CLEARWAY ORDERS  
 APFP REGULATION 5(2)(c)  
 SHEET 5 OF 10  
 DOCUMENT REFERENCE: 2.14

**SUITABILITY**  
 APPLICATION SUBMISSION

SHEET SIZE: A1    SCALE: 1:1250    STATUS: REV 01

**DRAWING NUMBER**  
 HES51511-VFK-LSI-X\_XXXX\_XX-DR-ZL-8038

© Crown copyright and database rights 2022. Use of this data is subject to terms and conditions. Ordnance Survey Licence: 100030649.

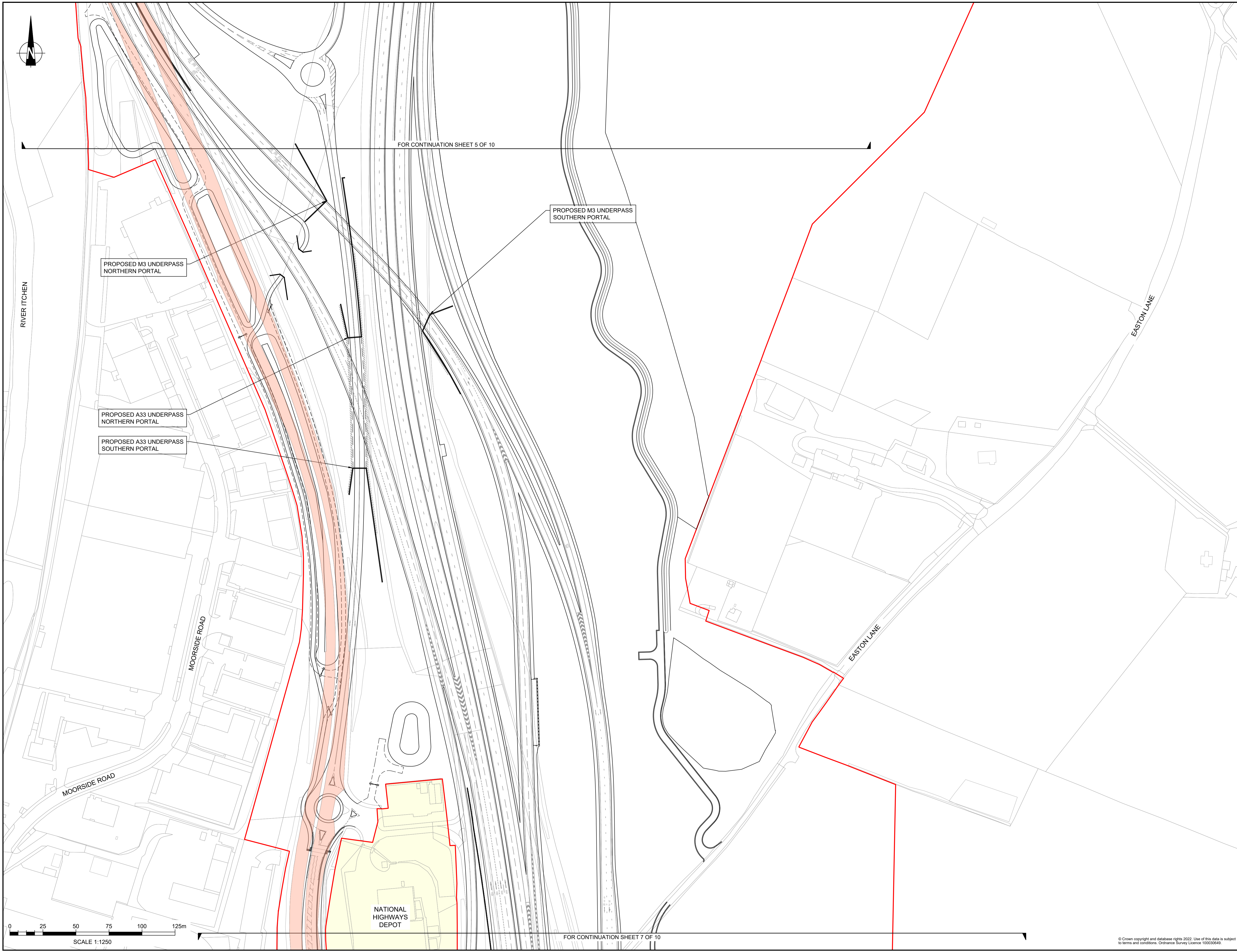

FOR CONTINUATION SHEET 5 OF 10

PROPOSED M3 UNDERPASS  
SOUTHERN PORTAL

PROPOSED M3 UNDERPASS  
NORTHERN PORTAL

PROPOSED A33 UNDERPASS  
NORTHERN PORTAL

PROPOSED A33 UNDERPASS  
SOUTHERN PORTAL

NATIONAL  
HIGHWAYS  
DEPOT

FOR CONTINUATION SHEET 7 OF 10

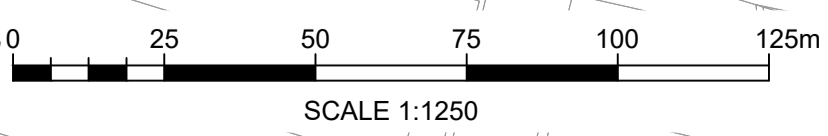
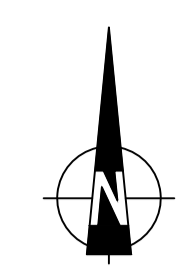

**NOTES**

Purpose of use  
**APPLICATION SUBMISSION**  
Development Consent Order Number / Document  
TR010055/2.14

- THIS DRAWING HAS BEEN PRODUCED USING CAD SOFTWARE. THEREFORE ALL DIMENSIONS ARE SHOWN IN METRES UNLESS SHOWN OTHERWISE.
- DO NOT SCALE FROM THIS DRAWING. USE ONLY PRINTED DIMENSIONS.
- PROPOSED EARTHWORK EMBANKMENTS / CUTTINGS HAVE BEEN OMITTED FOR CLARITY.
- THE DESIGN SHOWN WILL BE SUBJECT TO DETAILED DESIGN DEVELOPMENT IN ACCORDANCE WITH THE PROVISIONS OF THE DEVELOPMENT CONSENT ORDER.

**KEY TO SYMBOLS**

- DEVELOPMENT CONSENT ORDER BOUNDARY
- LAND NOT INCLUDED IN ORDER LIMITS
- PROPOSED ROAD MARKINGS
- EXISTING CLEARWAY EXTENTS TO BE REVOKED
- START / END POINT AS DETAILED IN SCHEDULE 3 OF THE DEVELOPMENT CONSENT ORDER

01	JUNE 2023	DEADLINE 2	EO	LC	MF
0	NOVEMBER 2022	APPLICATION SUBMISSION	GP	LC	MF
REV	DATE	REVISION NOTE	ORIG	CHKD	APPD

REFERENCE MAP

DESIGNER  
**Stantec**

CONTRACTOR  
**VolkerFitzpatrick**

CLIENT  
**national highways**

PROJECT TITLE  
M3 JUNCTION 9 IMPROVEMENT SCHEME

PROJECT STAGE  
PCF STAGE 3

DRAWING TITLE  
REVOKING EXISTING CLEARWAY ORDERS  
APFP REGULATION 5(2)(c)  
SHEET 6 OF 10  
DOCUMENT REFERENCE: 2.14

SUITABILITY  
APPLICATION SUBMISSION

SHEET SIZE: A1 | SCALE: 1:1250 | STATUS: REV 01

DRAWING NUMBER  
HES51511-VFK-LSI-X\_XXXX\_XX-DR-ZL-8039

© Crown copyright and database rights 2022. Use of this data is subject to terms and conditions. Ordnance Survey Licence 100030649.



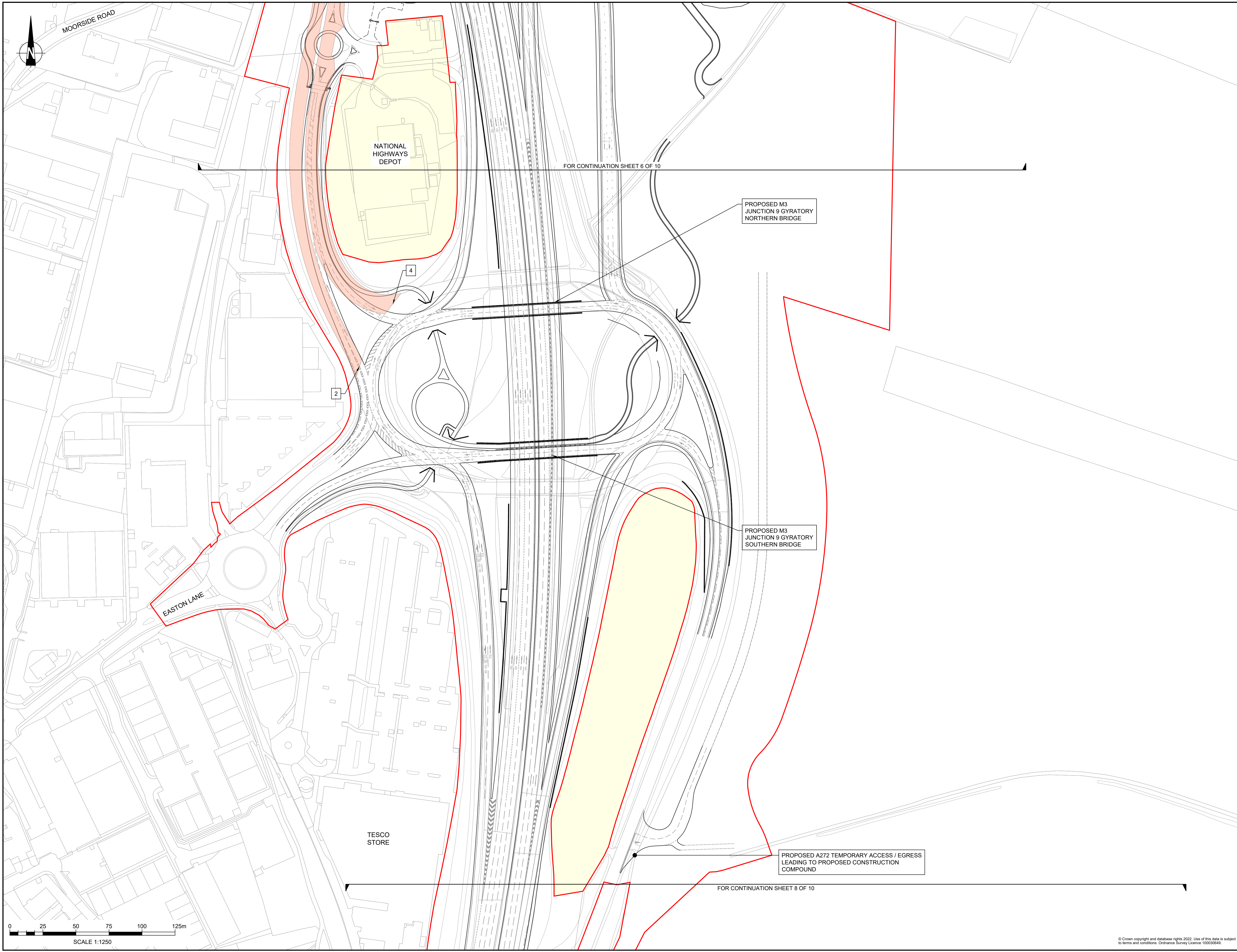

MOORSIDE ROAD

NATIONAL HIGHWAYS DEPOT

EASTON LANE

TESCO STORE

PROPOSED M3 JUNCTION 9 GYRATORY NORTHERN BRIDGE

PROPOSED M3 JUNCTION 9 GYRATORY SOUTHERN BRIDGE

PROPOSED A272 TEMPORARY ACCESS / EGRESS LEADING TO PROPOSED CONSTRUCTION COMPOUND

FOR CONTINUATION SHEET 6 OF 10

FOR CONTINUATION SHEET 8 OF 10

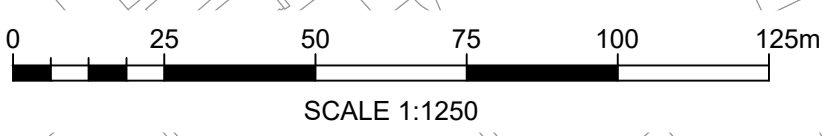

**NOTES**

Purpose of use  
**APPLICATION SUBMISSION**

Development Consent Order Number / Document  
 TR010055/2.14

- THIS DRAWING HAS BEEN PRODUCED USING CAD SOFTWARE. THEREFORE ALL DIMENSIONS ARE SHOWN IN METRES UNLESS SHOWN OTHERWISE.
- DO NOT SCALE FROM THIS DRAWING. USE ONLY PRINTED DIMENSIONS.
- PROPOSED EARTHWORK EMBANKMENTS / CUTTINGS HAVE BEEN OMITTED FOR CLARITY.
- THE DESIGN SHOWN WILL BE SUBJECT TO DETAILED DESIGN DEVELOPMENT IN ACCORDANCE WITH THE PROVISIONS OF THE DEVELOPMENT CONSENT ORDER.

**KEY TO SYMBOLS**

- DEVELOPMENT CONSENT ORDER BOUNDARY
- LAND NOT INCLUDED IN ORDER LIMITS
- PROPOSED ROAD MARKINGS
- EXISTING CLEARWAY EXTENTS TO BE REVOKED
- START / END POINT AS DETAILED IN SCHEDULE 3 OF THE DEVELOPMENT CONSENT ORDER

REV	DATE	REVISION NOTE	ORIG	CHKD	APPD
01	JUNE 2023	DEADLINE 2	EO	LC	MF
0	NOVEMBER 2022	APPLICATION SUBMISSION	GP	LC	MF

REFERENCE MAP

DESIGNER  
 Stantec

CONTRACTOR  
 VolkerFitzpatrick

CLIENT  
 national highways

PROJECT TITLE  
 M3 JUNCTION 9 IMPROVEMENT SCHEME

PROJECT STAGE  
 PCF STAGE 3

DRAWING TITLE  
 REVOKING EXISTING CLEARWAY ORDERS APFP REGULATION 5(2)(c) SHEET 7 OF 10 DOCUMENT REFERENCE: 2.14

SUITABILITY  
 APPLICATION SUBMISSION

SHEET SIZE: A1 SCALE: 1:1250 STATUS: REV 01

DRAWING NUMBER  
 HES51511-VFK-LSI-X\_XXXX\_XX-DR-ZL-6040

© Crown copyright and database rights 2022. Use of this data is subject to terms and conditions. Ordnance Survey Licence 100030640



TESCO STORE

FOR CONTINUATION SHEET 7 OF 10

ST SWITHUN'S SCHOOL

ALRESFORD ROAD

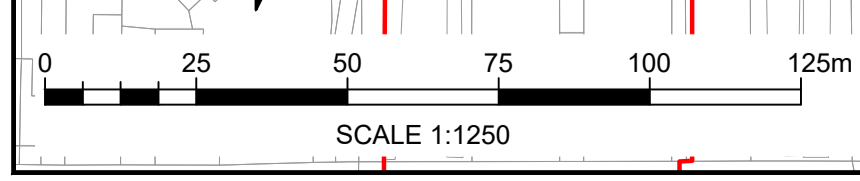

FOR CONTINUATION SHEET 8 OF 10

NOTES  
 Purpose of use  
**APPLICATION SUBMISSION**  
 Development Consent Order Number / Document  
**TR010055/2.14**

- THIS DRAWING HAS BEEN PRODUCED USING CAD SOFTWARE. THEREFORE ALL DIMENSIONS ARE SHOWN IN METRES UNLESS SHOWN OTHERWISE.
- DO NOT SCALE FROM THIS DRAWING. USE ONLY PRINTED DIMENSIONS.
- PROPOSED EARTHWORK EMBANKMENTS / CUTTINGS HAVE BEEN OMITTED FOR CLARITY.
- THE DESIGN SHOWN WILL BE SUBJECT TO DETAILED DESIGN DEVELOPMENT IN ACCORDANCE WITH THE PROVISIONS OF THE DEVELOPMENT CONSENT ORDER.

KEY TO SYMBOLS

- DEVELOPMENT CONSENT ORDER BOUNDARY
- LAND NOT INCLUDED IN ORDER LIMITS
- PROPOSED ROAD MARKINGS
- EXISTING CLEARWAY EXTENTS TO BE REVOKED
- START / END POINT AS DETAILED IN SCHEDULE 3 OF THE DEVELOPMENT CONSENT ORDER

01	JUNE 2023	DEADLINE 2	EO	LC	MF
0	NOVEMBER 2022	APPLICATION SUBMISSION	GP	LC	MF
REV	DATE	REVISION NOTE	ORIG	CHKD	APPD

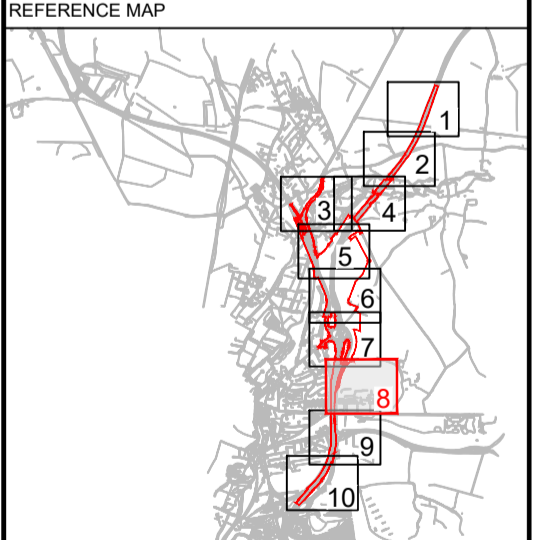

DESIGNER

CONTRACTOR

CLIENT

PROJECT TITLE  
**M3 JUNCTION 9 IMPROVEMENT SCHEME**

PROJECT STAGE  
**PCF STAGE 3**

DRAWING TITLE  
**REVOKING EXISTING CLEARWAY ORDERS  
 APFP REGULATION 5(2)(o)  
 SHEET 8 OF 10  
 DOCUMENT REFERENCE: 2.14**

SUITABILITY  
**APPLICATION SUBMISSION**  
 SHEET SIZE: A1 | SCALE: 1:1250 | STATUS: REV 01  
 DRAWING NUMBER  
 HES51511-VFK-LSI-X\_XXXX\_XX-DR-ZL-6041

© Crown copyright and database rights 2022. Use of this data is subject to terms and conditions. Ordnance Survey Licence 100030449

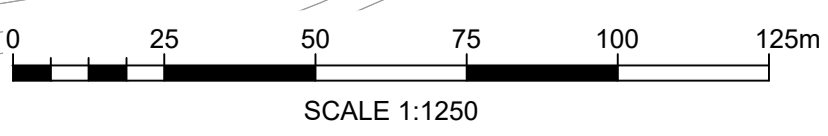
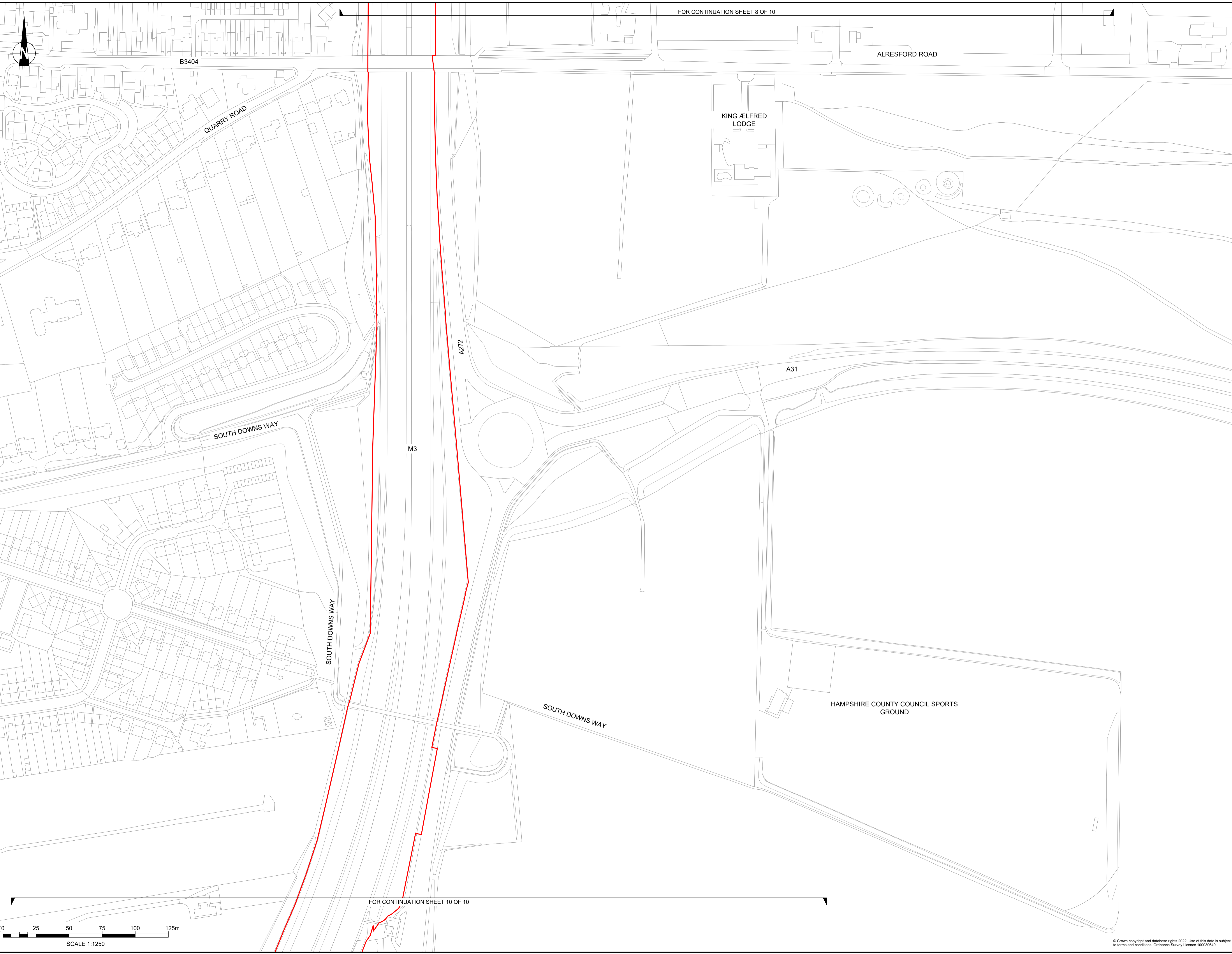

**NOTES**

Purpose of use  
**APPLICATION SUBMISSION**  
 Development Consent Order Number / Document  
 TR010055/2.14

- THIS DRAWING HAS BEEN PRODUCED USING CAD SOFTWARE. THEREFORE ALL DIMENSIONS ARE SHOWN IN METRES UNLESS SHOWN OTHERWISE.
- DO NOT SCALE FROM THIS DRAWING. USE ONLY PRINTED DIMENSIONS.
- PROPOSED EARTHWORK EMBANKMENTS / CUTTINGS HAVE BEEN OMITTED FOR CLARITY.
- THE DESIGN SHOWN WILL BE SUBJECT TO DETAILED DESIGN DEVELOPMENT IN ACCORDANCE WITH THE PROVISIONS OF THE DEVELOPMENT CONSENT ORDER.

**KEY TO SYMBOLS**

- DEVELOPMENT CONSENT ORDER BOUNDARY
- LAND NOT INCLUDED IN ORDER LIMITS
- PROPOSED ROAD MARKINGS
- EXISTING CLEARWAY EXTENTS TO BE REVOKED
- START / END POINT AS DETAILED IN SCHEDULE 3 OF THE DEVELOPMENT CONSENT ORDER

01	JUNE 2023	DEADLINE 2	EO	LC	MF
0	NOVEMBER 2022	APPLICATION SUBMISSION	GP	LC	MF
REV	DATE	REVISION NOTE	ORIG	CHKD	APPD

REFERENCE MAP

DESIGNER  
**Stantec**

CONTRACTOR  
**VolkerFitzpatrick**

CLIENT  
**national highways**

PROJECT TITLE  
 M3 JUNCTION 9 IMPROVEMENT SCHEME

PROJECT STAGE  
 PCF STAGE 3

DRAWING TITLE  
 REVOKING EXISTING CLEARWAY ORDERS  
 APFP REGULATION 5(2)(o)  
 SHEET 9 OF 10  
 DOCUMENT REFERENCE: 2.14

SUITABILITY  
 APPLICATION SUBMISSION

SHEET SIZE: A1 | SCALE: 1:1,250 | STATUS: REV 01  
 DRAWING NUMBER  
 HES51511-VFK-LSI-X\_XXXX\_XX-DR-ZL-6042

© Crown copyright and database rights 2022. Use of this data is subject to terms and conditions. Ordnance Survey Licence 100030649.



FOR CONTINUATION SHEET 8 OF 10

KING GEORGE V PLAYING FIELDS

WINCHESTER BYPASS

CHILCOMB LANE

SOUTHAMPTON

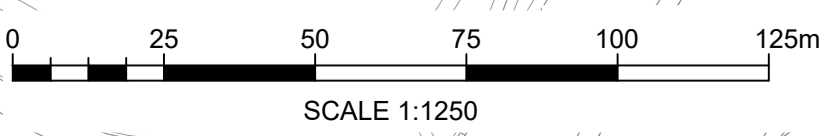

NOTES

Purpose of use  
**APPLICATION SUBMISSION**  
 Development Consent Order Number / Document  
 TR010055/2.14

- THIS DRAWING HAS BEEN PRODUCED USING CAD SOFTWARE. THEREFORE ALL DIMENSIONS ARE SHOWN IN METRES UNLESS SHOWN OTHERWISE.
- DO NOT SCALE FROM THIS DRAWING. USE ONLY PRINTED DIMENSIONS.
- PROPOSED EARTHWORK EMBANKMENTS / CUTTINGS HAVE BEEN OMITTED FOR CLARITY.
- THE DESIGN SHOWN WILL BE SUBJECT TO DETAILED DESIGN DEVELOPMENT IN ACCORDANCE WITH THE PROVISIONS OF THE DEVELOPMENT CONSENT ORDER.

KEY TO SYMBOLS

- DEVELOPMENT CONSENT ORDER BOUNDARY
- LAND NOT INCLUDED IN ORDER LIMITS
- PROPOSED ROAD MARKINGS
- EXISTING CLEARWAY EXTENTS TO BE REVOKED
- START / END POINT AS DETAILED IN SCHEDULE 3 OF THE DEVELOPMENT CONSENT ORDER

REV	DATE	REVISION NOTE	ORIG	CHKD	APPD
01	JUNE 2023	DEADLINE 2	EO	LC	MF
0	NOVEMBER 2022	APPLICATION SUBMISSION	GP	LC	MF

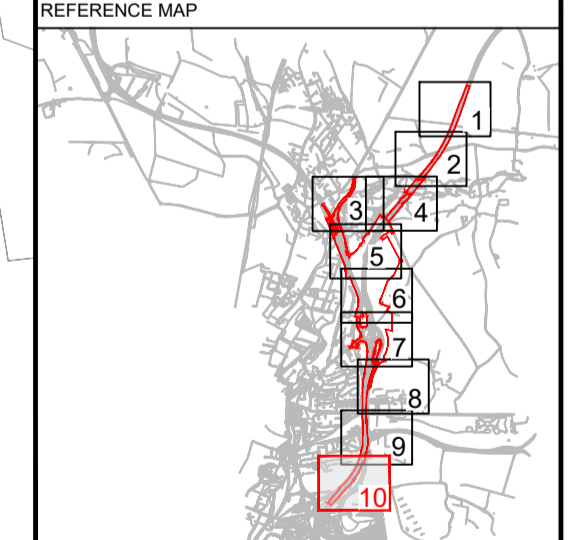

DESIGNER

CONTRACTOR

CLIENT

PROJECT TITLE  
 M3 JUNCTION 9 IMPROVEMENT SCHEME

PROJECT STAGE  
 PCF STAGE 3

DRAWING TITLE  
 REVOKING EXISTING CLEARWAY ORDERS  
 APFP REGULATION 5(2)(o)  
 SHEET 10 OF 10  
 DOCUMENT REFERENCE: 2.14

SUITABILITY  
 APPLICATION SUBMISSION

SHEET SIZE: A1 SCALE: 1:1250 STATUS: REV 01  
 DRAWING NUMBER  
 HES51511-VFK-LSI-X\_XXXX\_XX-DR-ZL-6043

© Crown copyright and database rights 2022. Use of this data is subject to terms and conditions. Ordnance Survey Licence 100030649